

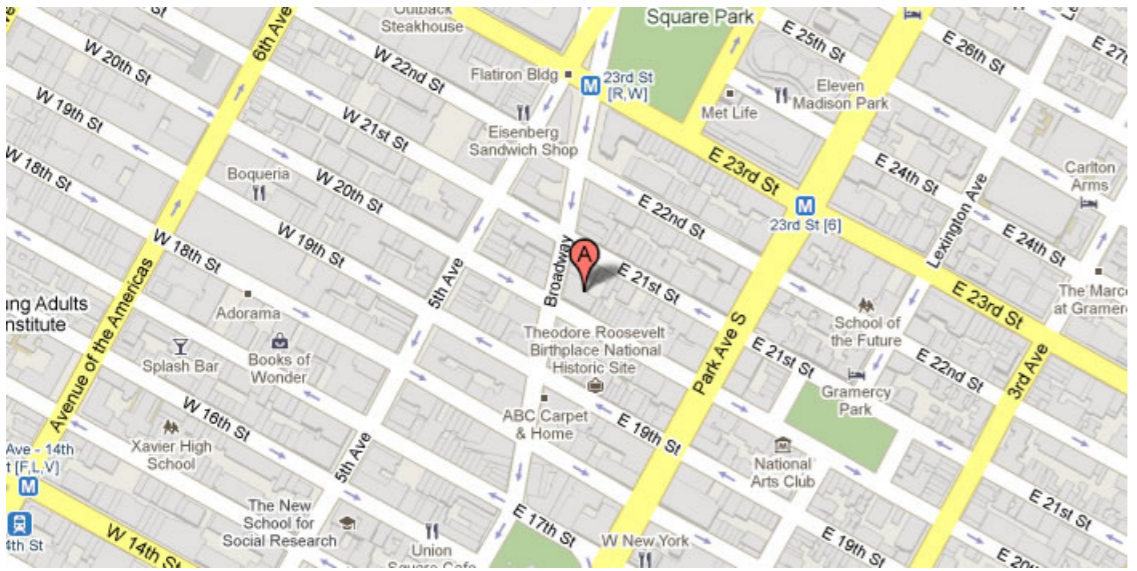

902 BROADWAY, New York, NY 10010



391576 SF

Up to 118,796 SF Available

Office building with modern lobby, private A/C upgraded elevators, 24/7 access, full floor identity and wood floors

Built: 1913 Architect: Robert T. Lyons

Tenants

Safavieh Rugs, Furniture and Design

For more information call

1- 212- 249- 1550

KOEPEL ROSEN

40 East 69th Street

New York, NY 10021

mkoepfel@koeppelrosen.com

902 BROADWAY, New York, NY 10010

902 Broadway



Typical Floor Plan

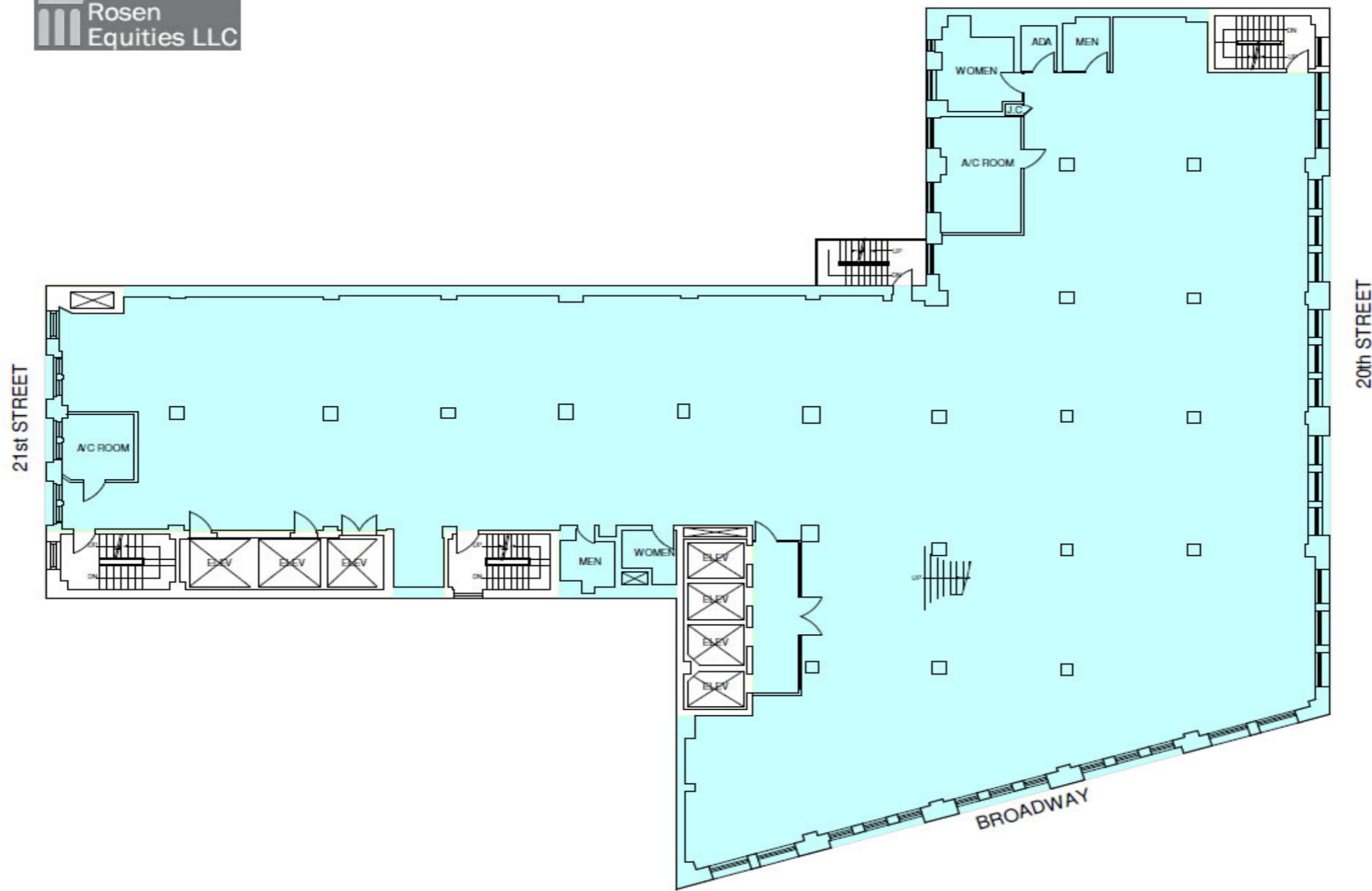

Note: All dimensions and conditions are approximate and for information only

 Koeppel Rosen LLC

40 East 69th Street
New York, NY 10021
212-249-1550
www.koeppe Rosen.com

Scale: NTS
Date: February 18, 2016



 LINK
SYSTEMS

For more information call
1-212-249-1550
KOEPEL ROSEN
40 East 69th Street
New York, NY 10021
mkoeppe Rosen@koeppe Rosen.com