

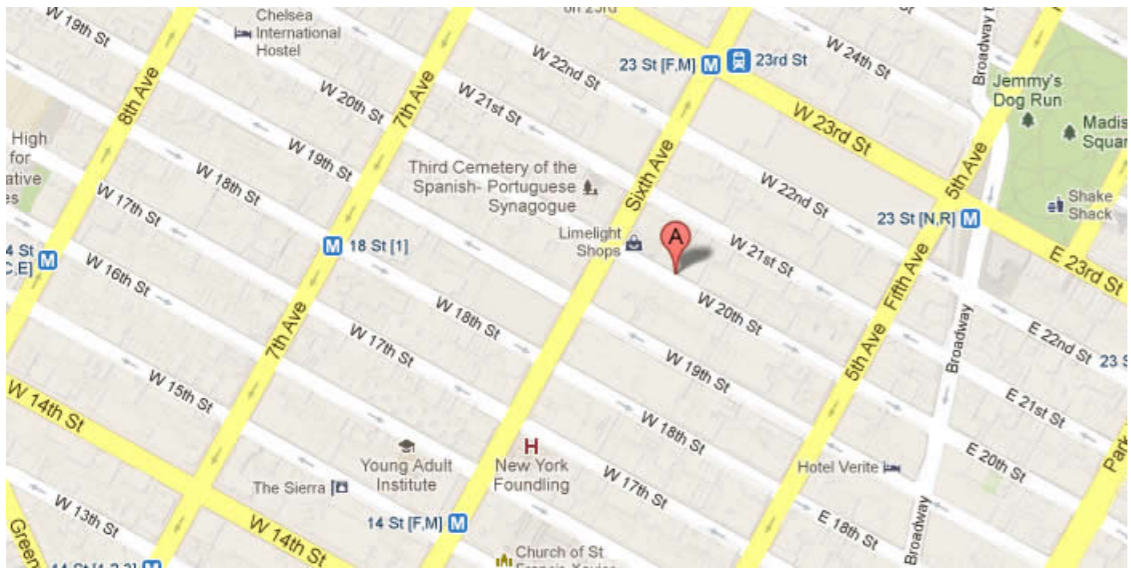

37 WEST 20TH STREET, New York, NY 10011



126470 SF

Up to 42,085 SF Available

This 12 story first class office building, located in the heart of the Flatiron District, features 24/7 hour building security, renovated lobby and common areas, new bathrooms, new windows and new elevators. Located in landmark district. Built: 1909 Architect: Sommerfeld & Franke

Tenants

Marissa Vosper
Chelsea Foot and Ankle PC
Steve Stone
Tony Cassella
Marie Pense Center LLC

For more information call

1- 212- 564- 6662

OLMSTEAD PROPERTIES

575 Eighth Avenue, Suite 2400

New York, NY 10018

info@olmsteadinc.com

37 WEST 20TH STREET, New York, NY 10011

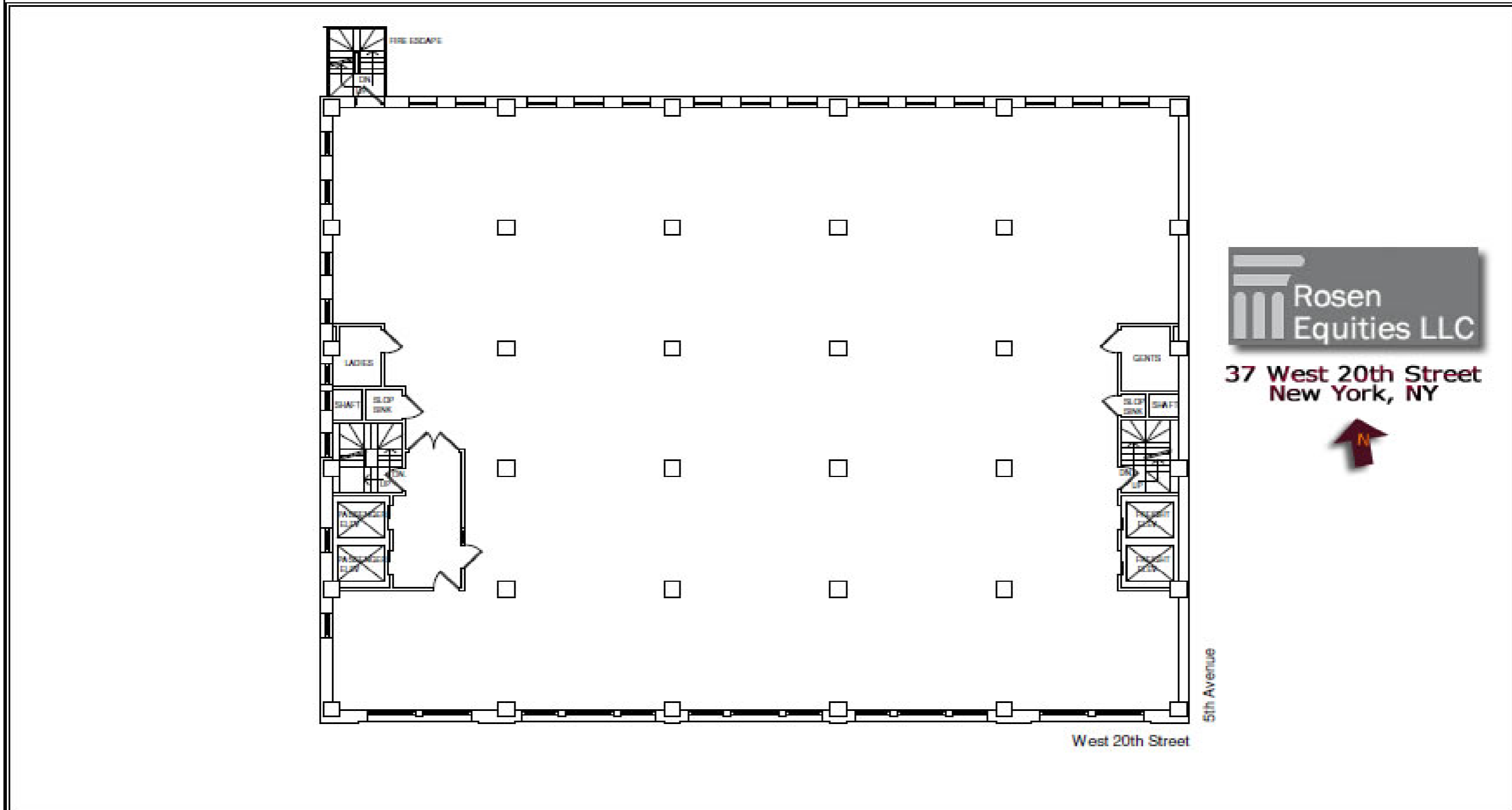

Leasing and Managing Agent



575 Eighth Avenue, Suite 2400
New York, NY 10018
(212) 564-6662
Fax: (212) 564-6667
www.olmsteadinc.com

Typical Floor Plan

All areas and dimensions
are approximate. Field
verification is necessary.
Date Printed: 1/30/2014

For more information call
1-212-564-6662
OLMSTEAD PROPERTIES
575 Eighth Avenue, Suite 2400
New York, NY 10018
info@olmsteadinc.com